

1. Drill a 3/32 [2.38mm] dia. hole, through each upper collar half, centering the hole on the collar.
2. Install the collars on JSX-C03-02.
3. Transfer the hole in each collar into the pushrod tube.
4. Install a 3/32" x 7/16" stainless steel roll pin flush with the surface of collar.

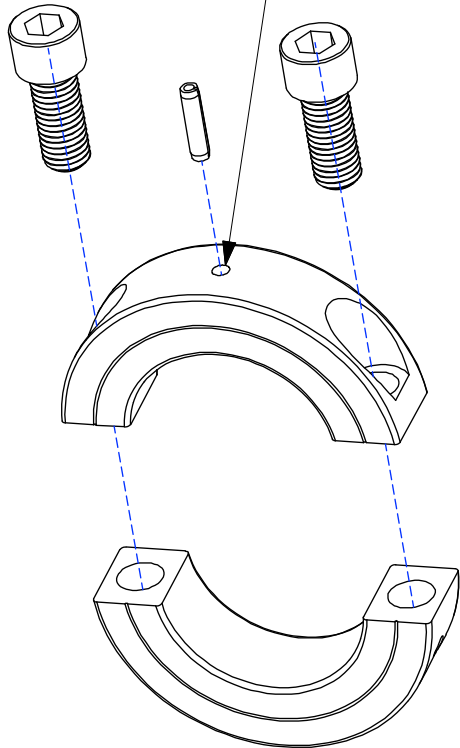

**Detail of Collars**  
Scale: Full

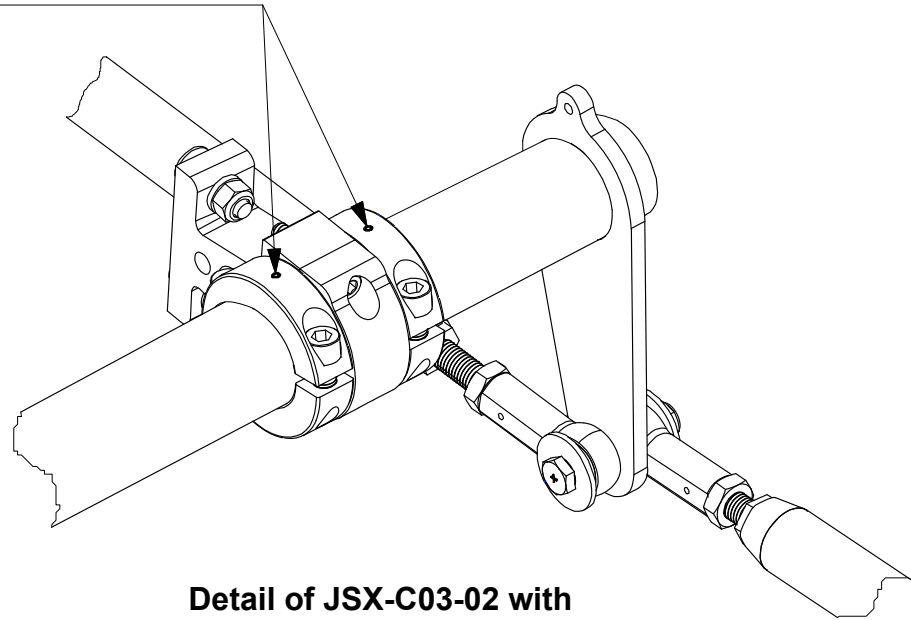

**Detail of JSX-C03-02 with Collars and Roll Pins Installed**  
Scale: 1/2

JSX-C03-48	1	Control System Rigging	JSX-C01
Dash / Part Number	Qty Req'd	Part Title	Next Assembly
<b><i>Sub</i> Sonex</b>			
<b>Control System Collar Roll Pin Install</b>			
Drawing Scale	Drawing Number	Revision	
Noted	JSX-SFC01	NC	